

MAGNETIC VARIATION 9° W-2020

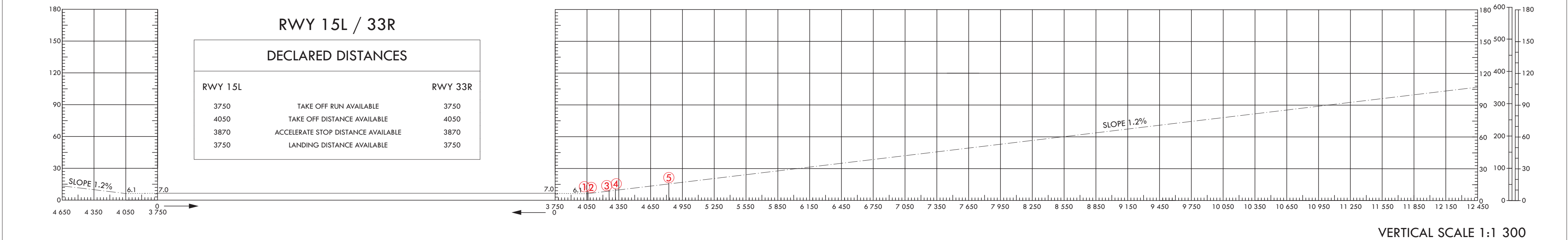

MAGNETIC VARIATION 9° W-2020

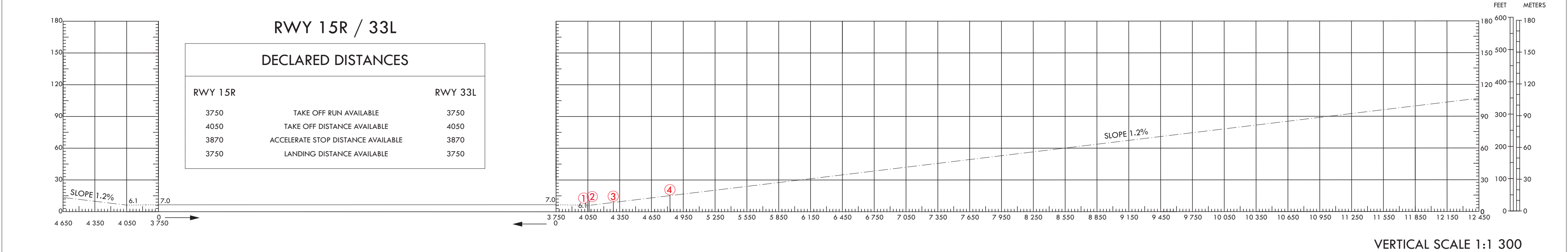

MAGNETIC VARIATION 9° W-2020

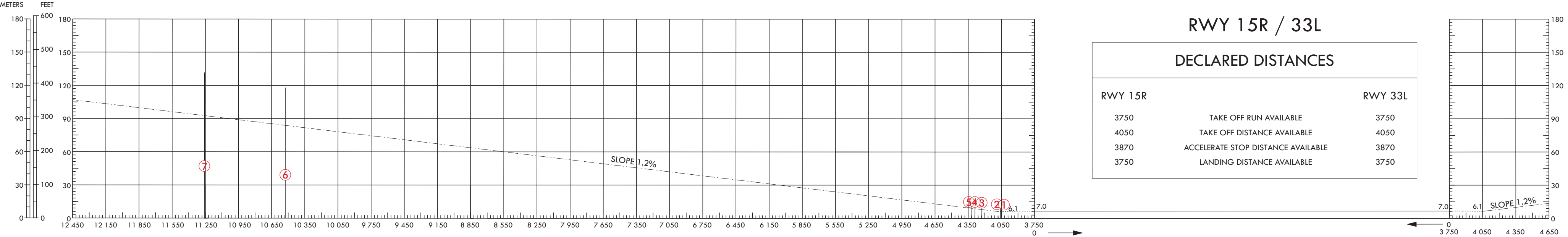

VERTICAL SCALE 1:1 300

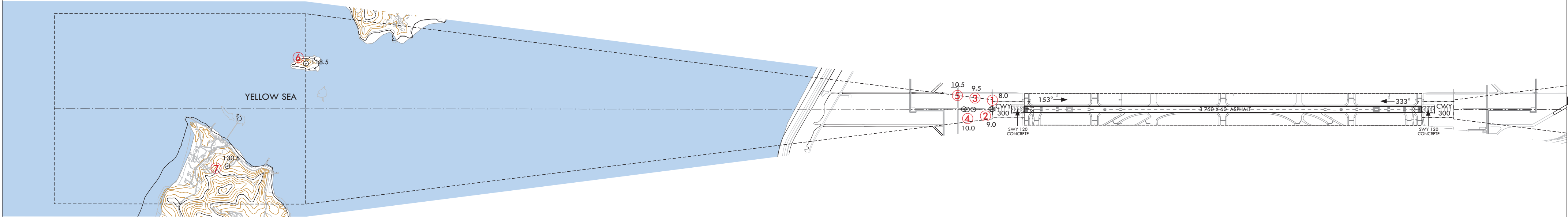

LEGEND		
ITEM	SYMBOL	
	Plan	Profile
Tree or shrub	✱	
Pole tower spire antenna etc	⊙	
Building or large structure	■	
Railroad	—+—+—	
Transmission line or overhead cable	T—T—T	
Natural High Point(Peak or Mountain)	●	
Terrain penetrating obstacle plane		
Stopway(SWY)		
Clearway(CWY)		

OBSTACLES					
NR	COORDINATES(WGS-84)		ELEV(AMSL)	ITEM	NOTE
1	37°29'02.4"N	126°26'03.8"E	8.0	Light	
2	37°29'02.7"N	126°26'03.5"E	9.0	Antenna	
3	37°29'07.1"N	126°25'59.5"E	9.5	Light	
4	37°29'08.7"N	126°25'58.1"E	10.0	Light	
5	37°29'09.5"N	126°25'57.4"E	10.5	Light	
6	37°32'01.7"N	126°23'45.5"E	119.0	Tower	
7	37°32'03.9"N	126°22'55.8"E	130.5	Tower	

ORDER OF ACCURACY

HORIZONTAL 5.0 m
VERTICAL 0.5 m

HORIZONTAL SCALE 1 : 13 000

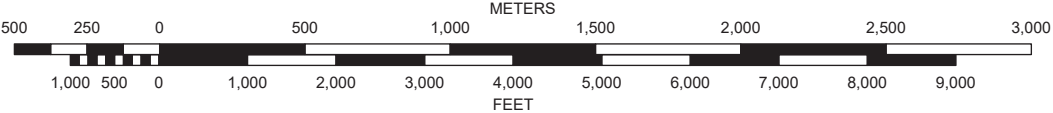

AMENDMENT RECORD		
NR.	DATE	ENTERED BY

MAGNETIC VARIATION 9° W-2020

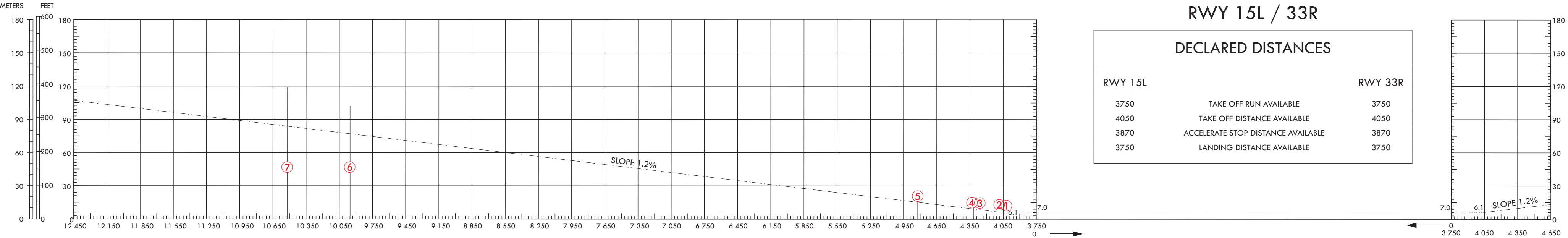

VERTICAL SCALE 1:1 300

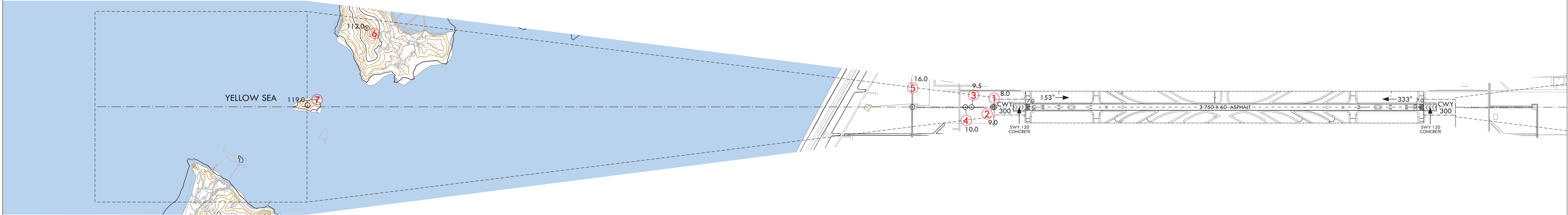

MAGNETIC VARIATION 9° W - 2020

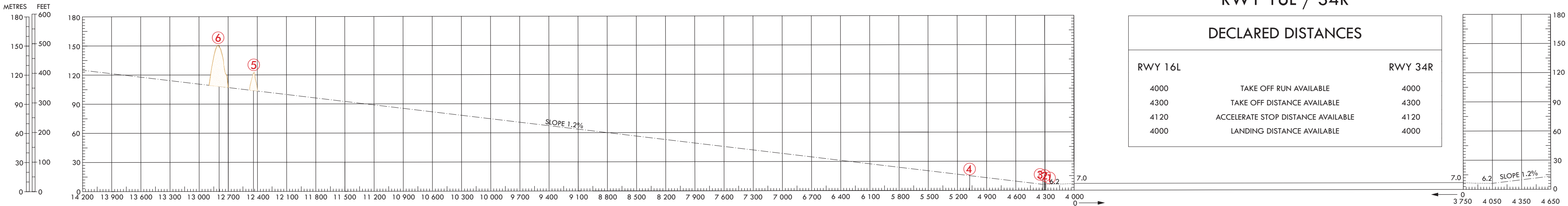

VERTICAL SCALE 1:1500

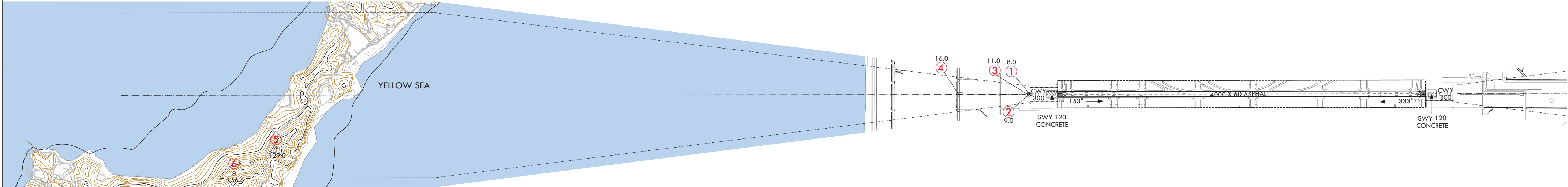

LEGEND		
ITEM	SYMBOL	
	Plan	Profile
Tree or shrub	✱	
Pole tower spire antenna etc	⊙	
Building or large structure	■	
Railroad	—+—+—	
Transmission line or overhead cable	—T—T—T—	
Natural High Point(Peak or Mountain)	●	
Terrain penetrating obstacle plane		
Stopway(SWY)		
Clearway(CWY)		

OBSTACLES					
NR	COORDINATES(WGS-84)		ELEV(AMSL)	ITEM	NOTE
1	37°28'30.1"N	126°24'48.9"E	8.0	Light	
2	37°28'30.3"N	126°24'48.7"E	9.0	Antenna	
3	37°28'30.8"N	126°24'48.3"E	11.0	Antenna	
4	37°28'50.7"N	126°24'30.6"E	16.0	CCTV	
5	37°31'56.1"N	126°21'16.3"E	129.0	Natural high Point	
6	37°32'03.2"N	126°20'56.5"E	156.5	Natural high Point	

ORDER OF ACCURACY

HORIZONTAL 5.0 m
VERTICAL 0.5 m

HORIZONTAL SCALE 1 : 15000

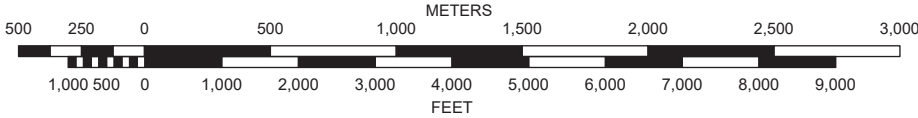

AMENDMENT RECORD		
NR.	DATE	ENTERED BY

MAGNETIC VARIATION 9° W-2020

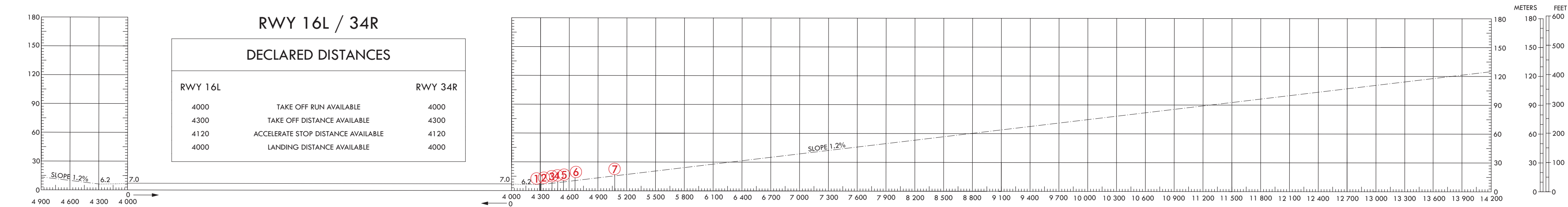

VERTICAL SCALE 1:1300

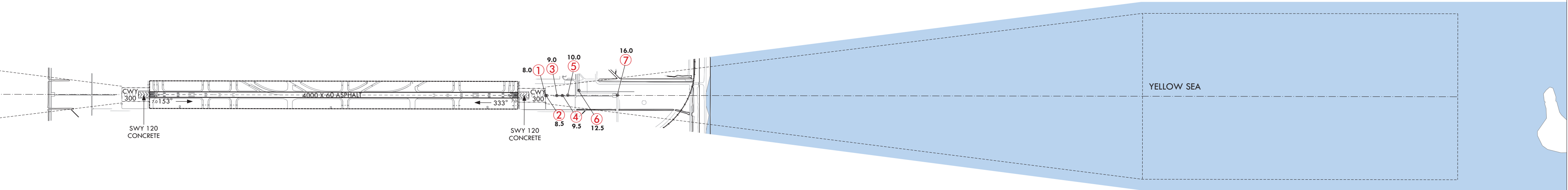

LEGEND		
ITEM	SYMBOL	
	Plan	Profile
Tree or shrub	✳	
Pole tower spire antenna etc	⊙	
Building or large structure	■	
Railroad	—+—+—+—	
Transmission line or overhead cable	—T—T—T—	
Natural High Point(Peak or Mountain)	●	
Terrain penetrating obstacle plane		
Stopway(SWY)		
Clearway(CWY)		

OBSTACLES					
NR	COORDINATES(WGS84)		ELEV(MSL)	ITEM	NOTE
1	37° 26' 28.2 "N	126° 26' 37.3 "E	8.0	Light	
2	37° 26' 28.0 "N	126° 26' 37.5 "E	8.5	Antenna	
3	37° 26' 25.1 "N	126° 26' 40.2 "E	9.0	Light	
4	37° 26' 23.5 "N	126° 26' 41.6 "E	9.5	Light	
5	37° 26' 21.9 "N	126° 26' 43.0 "E	10.0	Light	
6	37° 26' 19.9 "N	126° 26' 47.6 "E	12.5	CCTV	
7	37° 26' 07.7 "N	126° 26' 55.7 "E	16.0	CCTV	

HORIZONTAL SCALE 1 : 15000

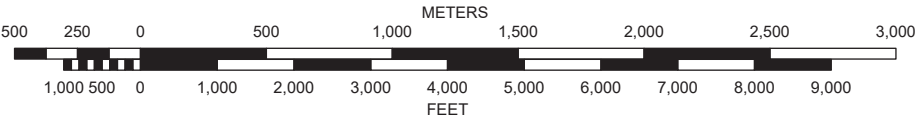

ORDER OF ACCURACY

HORIZONTAL 5.0 m
VERTICAL 0.5 m

AMENDMENT RECORD		
NR.	DATE	ENTERED BY

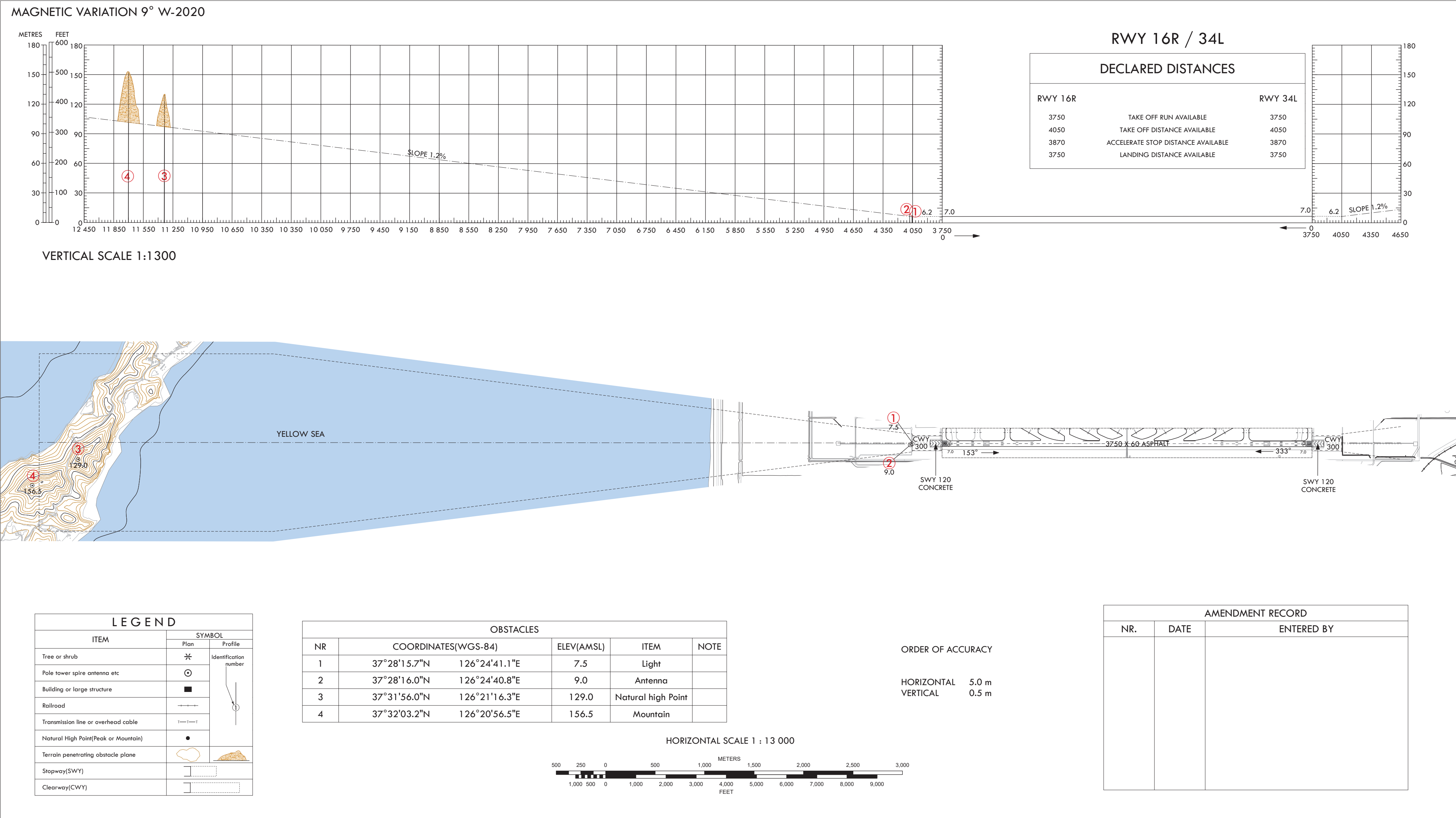

MAGNETIC VARIATION 9° W-2020

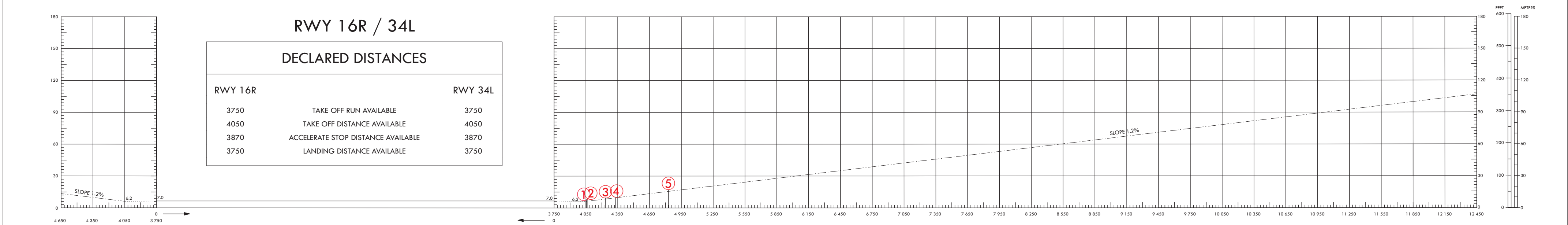

VERTICAL SCALE 1:1,300

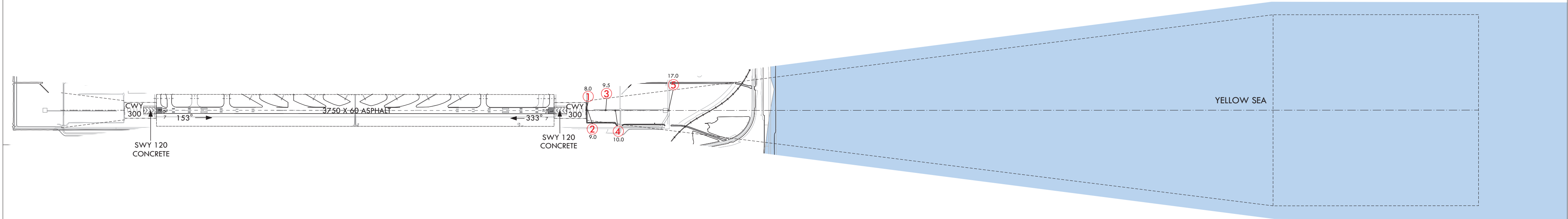

LEGEND		
ITEM	SYMBOL	
	Plan	Profile
Tree or shrub	✱	<div>Identification number</div>
Pole tower spire antenna etc	⊙	
Building or large structure	■	
Railroad	—+—+—	
Transmission line or overhead cable	—T—T—T—	
Natural High Point(Peak or Mountain)	●	
Terrain penetrating obstacle plane		
Stopway(SWY)		
Clearway(CWY)		

OBSTACLES					
NR	COORDINATES(WGS-84)		ELEV(AMSL)	ITEM	NOTE
1	37°26'20.5"N	126°26'23.6"E	8.0	Light	
2	37°26'20.2"N	126°26'23.9"E	9.0	Antenna	
3	37°26'15.7"N	126°26'27.9"E	9.5	Light	
4	37°26'13.2"N	126°26'30.0"E	10.0	Light	
5	37°25'59.9"N	126°26'41.9"E	17.0	CCTV	

ORDER OF ACCURACY

HORIZONTAL 5.0 m
VERTICAL 0.5 m

HORIZONTAL SCALE 1 : 13 000

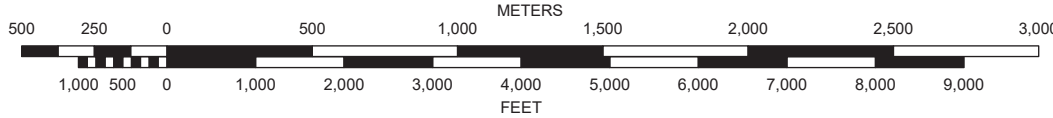

AMENDMENT RECORD		
NR.	DATE	ENTERED BY